

MATERIAL - CASE HARDENED CARBON STEEL -or-
OIL HARDENING STEEL (DARK STRAW COLOR)

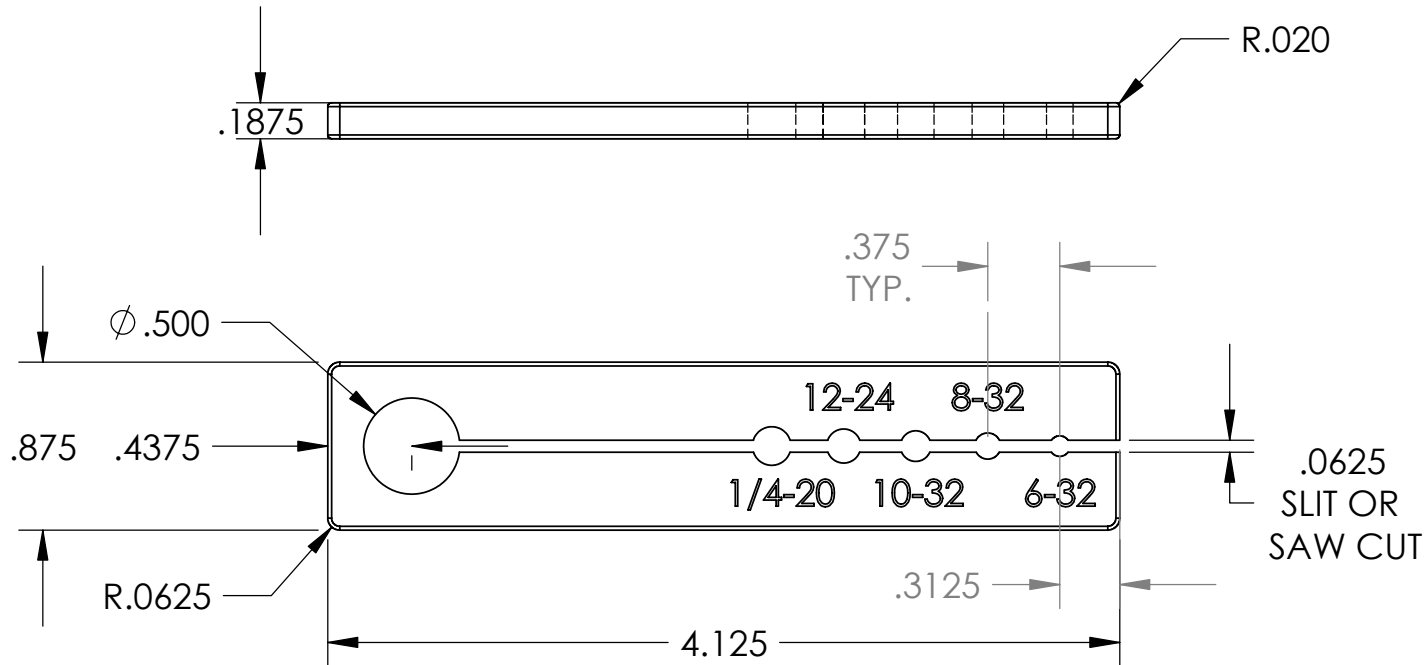
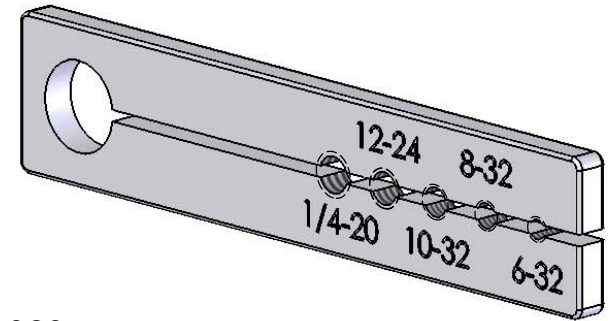

NOTES:

- 1 - THIS IS A VERY HANDY DEVICE FOR REDUCING THE LENGTH OF MACHINE SCREWS
- 2 - TO USE, THREAD THE FASTENER IN TO THE DESIRED LENGTH, CLAMP THE DEVICE IN A VICE, SAW CUT THE FASTENER, AND FILE THE END OF THE SCREW FLUSH WITH THE CLAMP
- 3 - CHANGE ANY DIMENSION TO SUIT YOUR NEEDS

DESIGNED BY: PAUL BEYER

SCREW CLAMP
FOR ALTERING LENGTH

DRAWN BY: N.P. SKINNER

Friday, May 26, 2006 REV 1

SCALE: 1:1 INCHES SHEET 1 OF 1

Upstate New York Home Shop Metalworkers
<http://www.gooseberryfarm.com/metalworking>